

OUTLET STRUCTURE TO BE MINIMUM 20' FROM PROPERTY LINE OR AS APPROVED BY FULTON COUNTY PUBLIC WORKS DEPT.

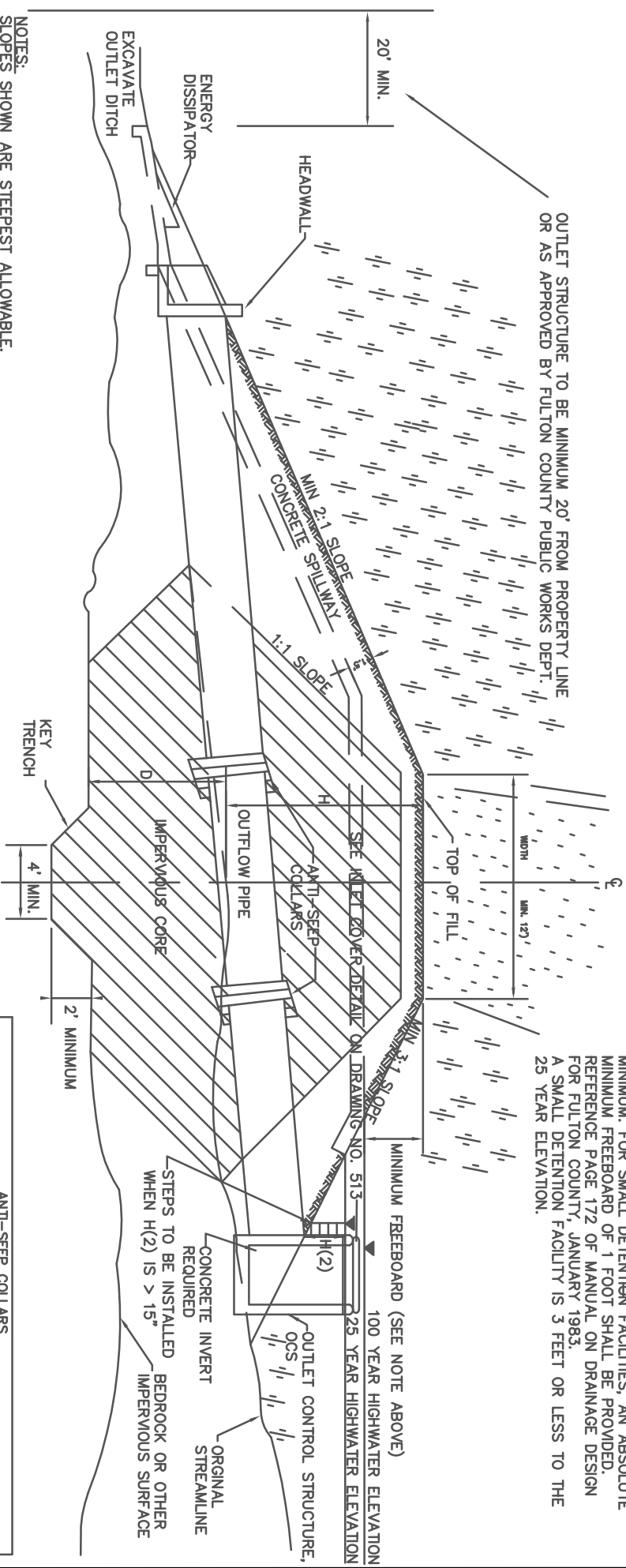

NOTES:  
IT IS PREFERABLE TO HAVE A FREEBOARD OF 2 FEET MINIMUM. FOR SMALL DETENTION FACILITIES, AN ABSOLUTE MINIMUM FREEBOARD OF 1 FOOT SHALL BE PROVIDED. REFERENCE PAGE 172 OF MANUAL ON DRAINAGE DESIGN FOR FULTON COUNTY, JANUARY 1983.  
A SMALL DETENTION FACILITY IS 3 FEET OR LESS TO THE 25 YEAR ELEVATION.

NOTES:  
SLOPES SHOWN ARE STEEPEST ALLOWABLE.  
CORE TO BE CLAY OR OTHER IMPERVIOUS MATERIAL.  
D, DEPTH OF CORE, MUST BE TO IMPERVIOUS MATERIAL OR A MINIMUM DEPTH EQUAL TO H.  
CORE TO BE PLACED IN 6" LAYERS & COMPACTED TO 95% STANDARD PROCTOR.  
WIDTH = (H/5) + 12.  
EMERGENCY SPILLWAYS ARE TO BE CUT IN NATURAL GROUND WHERE APPLICABLE.  
ANTI SEEP COLLARS REQUIRED. USE METAL SEEP COLLARS WITH METAL PIPE. USE CONCRETE OTHERWISE.  
ALTERNATE DESIGNS MAY BE APPROVED OR WILL BE CONSIDERED BY FULTON COUNTY PUBLIC WORKS.  
PROVIDE CONCRETE ONLY FOR OUTFLOW PIPE AND OUTLET STRUCTURE MATERIAL

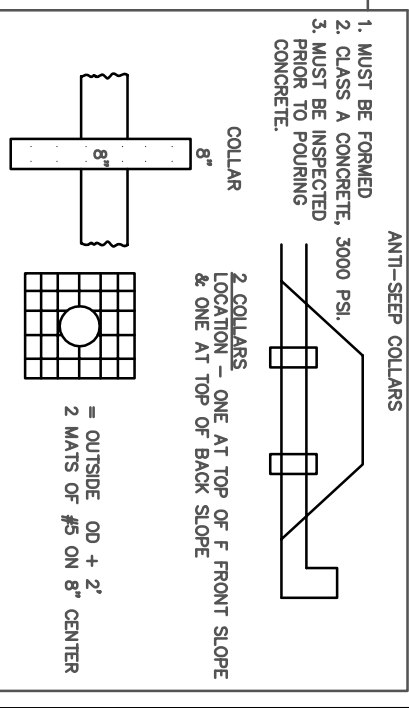
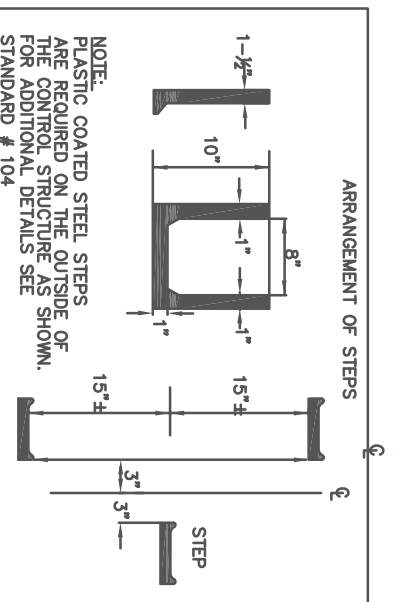

FULTON COUNTY STANDARD DETAIL 522

EARTH-FILL DAM  
FOR  
DETENTION PONDS

DATE	RC	REVISIONS	DATE	REVISIONS	DGS/DRN/CHKD:CMS	APPROVED: REW	DATE: 12-2-05
8/08							



FULTON COUNTY PUBLIC WORKS  
141 PRYOR ST. ATLANTA, GA. 30303  
404-612-7400 FAX: 404-224-0498

DRAWING NO. 522